

# Plastec roof hatch installation guide

---

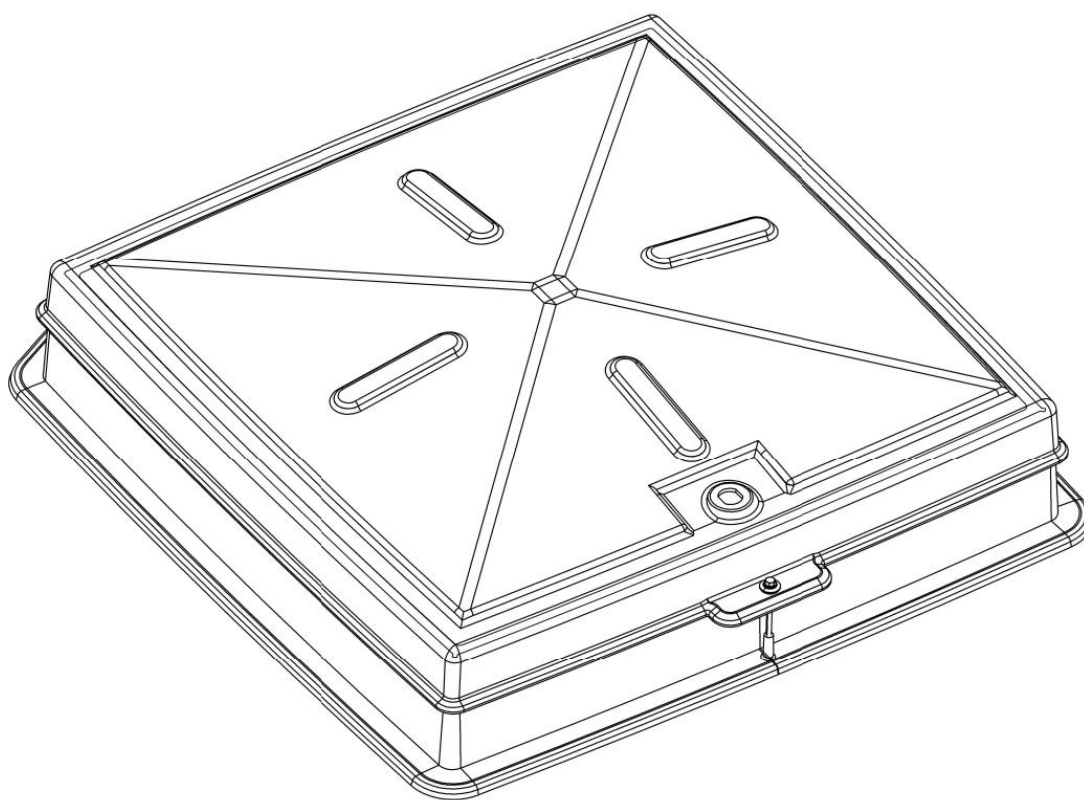

## Plastec roof hatch delivery contents

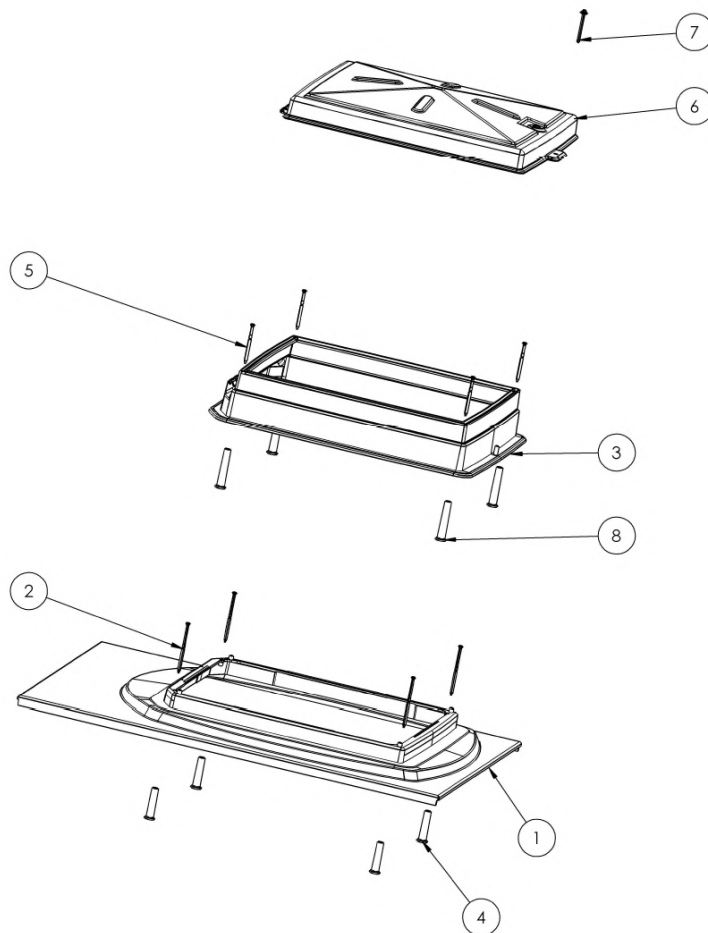

#	Part	Description	Quantity
1	Roof hatch base		1
2	Base fixing screw 6 x 140 mm		4
3	Hatch frame		1
4	Base support sleeve	L = 108 mm (< 40 mm profile) L=115 mm (40 – 60 mm profile)	8
5	Frame fixing screw 6 x 110 mm		4
6	Roof hatch lid		1
7	Lid locking screw 4,8 x 80 mm		1
8	Frame support sleeve	Installation between frame and base	4
	Underlay fixing clamp		4
	Sealing L-profile strip	Only for standing seam roofs	4
	Rothoblaas Flexi 60 tape	For sealing the underlay	5 m
	Roof hatch sealing strip	Expanding sealing strip	3,4 m

## General

These instructions apply to the installation of Plastec roof hatches.

For renovations, verify case-by-case suitability.

## Receiving the Product

- Check delivery contents match the order.
- Report any damages or missing items immediately on the consignment note.
- Plastec is not responsible for improper installations.

## Installing Plastec roof hatch

### 1. Positioning the Hatch

Top edge should go under ridge flashing. If not possible, use a cover plate between the hatch and the ridge flashing. A snow guard must be installed if the hatch is positioned more than 1 m below the ridge.

Align the hatch symmetrically on roof profile. Ensure that the opening avoids trusses. Install extra battens if needed for proper attachment.

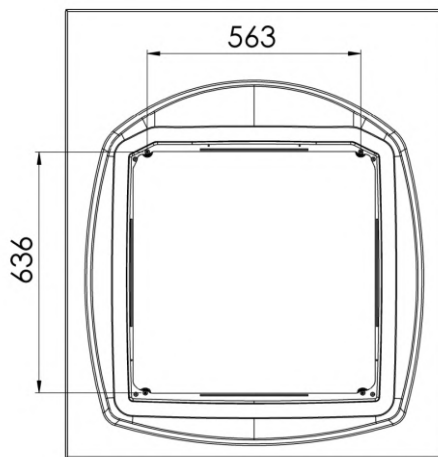

Picture 1. Measurements of the fixing points

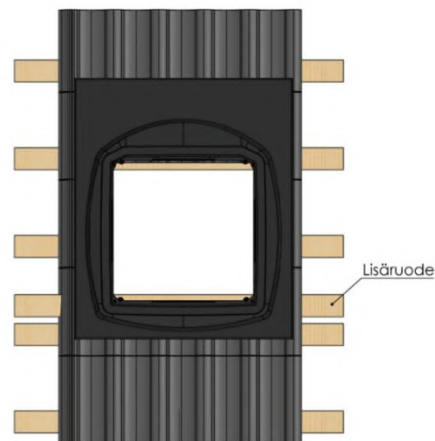

Picture 2. Add extra batten if necessary

## 2. Cutting the opening

Mark and cut approx. 600–650 mm x 600–650 mm opening. You can use the hatch as a template, make sure to position the hatch correctly before marking the opening. Make sure there are no trusses within the opening.

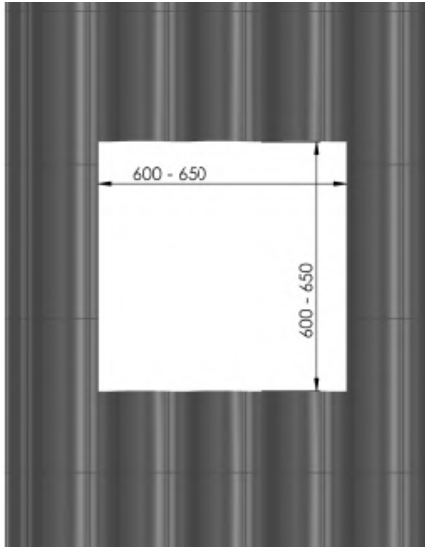

*Picture 3. Size of the opening*

## 3. Sealing the base

Apply the expanding sealing strip to the bottom of the roof hatch base according to the picture below.

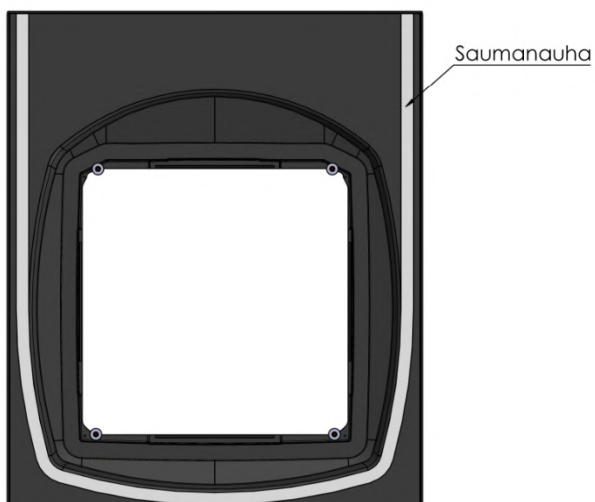

*Kuva 4. Expanding sealing strip attached to the base.*

#### 4. Sealing for standing seam roofs

When installing to a standing seam roof, install the additional L-profile strips along the bottom edge of the base of the hatch. These will seal the bottom and add support to the hatch. Fix L-profile with screws and neutral silicone (e.g., Silirub S2, not included in delivery).

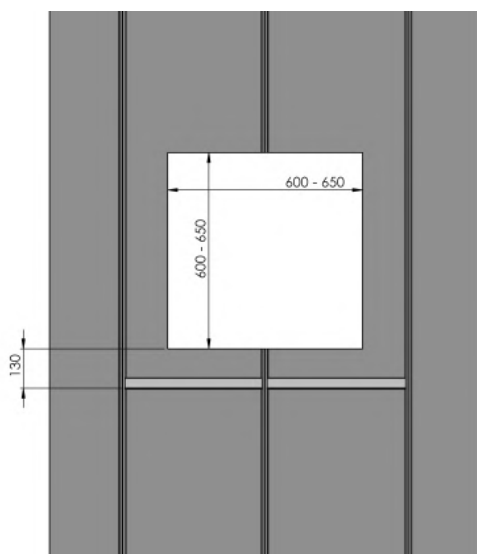

*Kuva 5. L-profile strips placement on a standing seam roof*

#### 5. Installing the base

Align base with cut opening. Select proper sleeves based on profile height according to the chart below. Place the sleeves under the base to proper positions (picture 6 below) and fix the base to the battens with 6 x 140 mm screws. When fixing to steel battens, use proper screws such as Ejoguard JT2-ST-2-6,0x140

Kate	Holkki
Profiled sheet < 40 mm	4x 108 mm
Profiled sheet 40–60 mm	4x 115 mm
Standing seam, profile lower than < 40 mm	4x 108 mm

*Chart1. Choosing the right sleeve according to the roofing*

Ensure that the base sits tightly against the roofing, not resting on sleeves. Trim the sleeves if necessary.



*Picture 6. Fixing the base to the battens with screws through the support sleeves.*

#### 6. Cutting and fixing the underlay

Cut underlay crosswise from corner to corner. Attach the loose underlay to the base using fixing clamps. When attached, trim the excess according to the dashed line as shown in picture 7.

Tape corners using the provided Rothoblaas FLEXI60 tape. Use 1.25 m per corner from included 5 m roll.

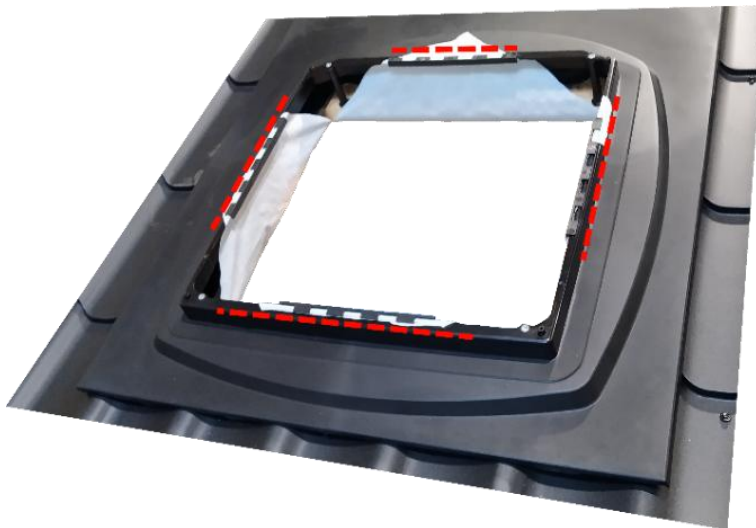

*Picture 7. Underlay cut and fixed to the base*

## 7. Attaching the hatch frame and lid

Place lid and frame on base with 84 mm sleeves in between. Fix the frame to the base using 6 x 110 mm screws (picture 8). Ensure proper alignment (picture 9).

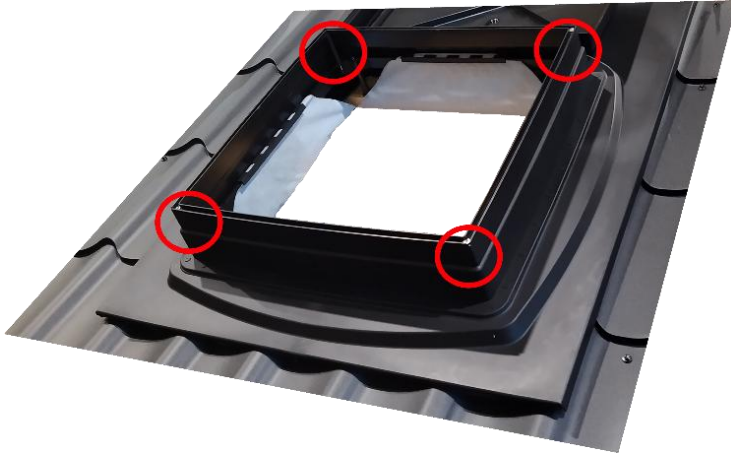

*Picture 8. Screw placement*



*Picture 9. Properly placed screw*

**NOTE! USE LOW TORQUE TO AVOID DAMAGE.**

## 8. Finalizing installation

Close and lock the lid. If necessary, insert 80 mm screw through lid into frame to secure lock (picture 10).



*Picture 10. Hatch locked and secured with a screw*



## Maintenance

Plastec roof hatches are long-lived and safe to use when maintained properly. To ensure safe use of the product, the following procedures are required annually:

- Check the lock function.
- Ensure that the lid is locked and stays shut after every service visit.
- Inspect all joints and fasteners.
- Remove excess snow to reduce load as needed.
- Replace or repair damaged parts promptly.



*Picture 11. Plastec roof hatch installed on a profiled sheet.*